

JCF35 Foot switch

Application field - Medical Line

Preferably in the control of physiotherapy bed, medical bed, drainage dentistry, treatment chair, computer workstation, and office table.

JCF35 has a compact design and Max. 5 rows of buttons to provide customers with more choices.



General Features

Buttons:	Max. 5 row buttons
Colour:	Gray
Controller matching:	Adapt to all conventional controllers of Jiecang
Max IP grade:	IP54
Operation:	Single action, linkage
Operating temperature:	+5°C to +40°C
Storage temperature:	-10°C to +50°C
Relative humidity:	20% to 80% (non-condensing)
Atmospheric pressure:	860 to 1060 hPa
Altitude:	Max. 2000m
Drive up:	5 motors move synchronized

Dimension Drawing

One row

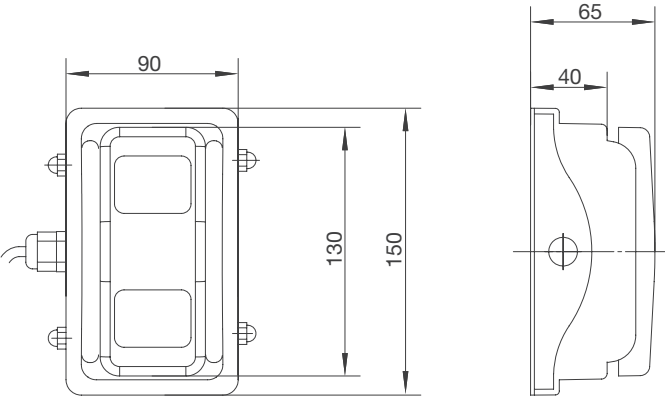

Two rows

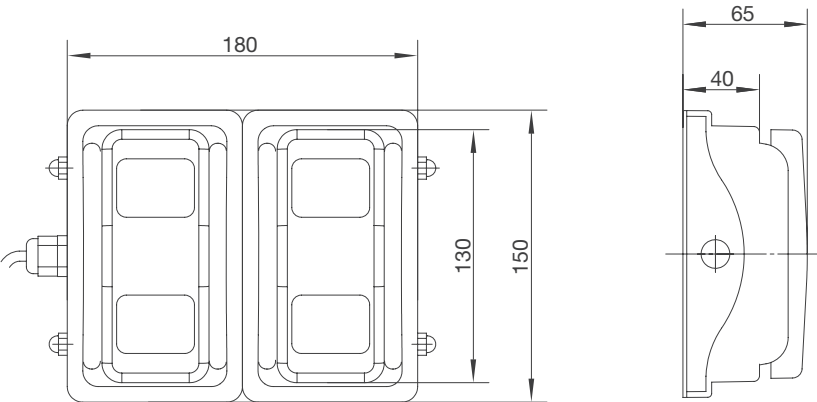

Three rows

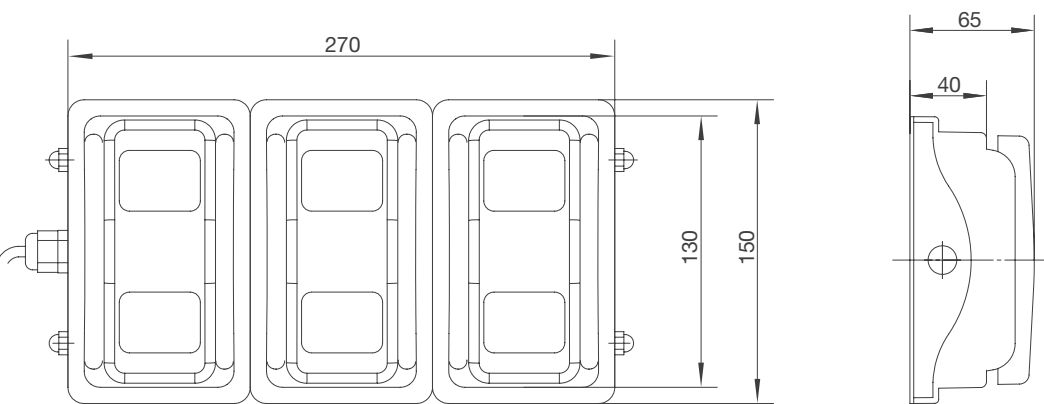

Four rows

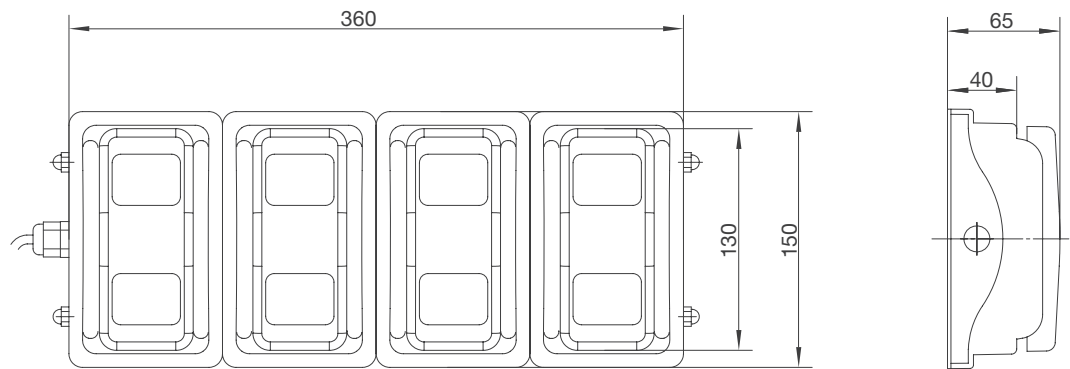

Five rows

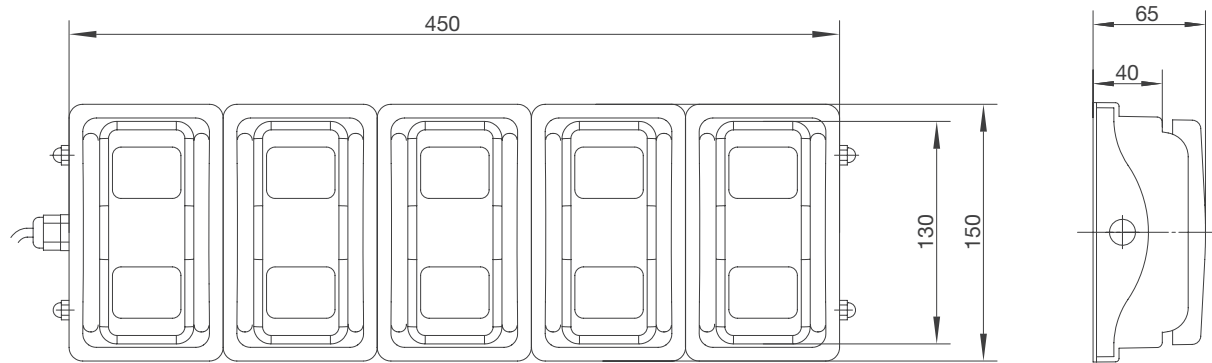

Ordering Key

Take **JCF35B3BB258L13D00** for example

Model	JCF35	
Extension functions	B	B = Without backlight
Rows of buttons	3	2 = 2 row buttons / 3 = 3 row buttons 4 = 4 row buttons / 5 = 5 row buttons
Color	B	G = Gray / B = Black
Panel code	B25	B25 = Specific code
Cable plug code	8L1	8L1 = 8pin DIN plug of spring cable 13L1 = 13pin DIN plug of spring cable 10P1 = 10pin crystal elbow flex plug of spring cable
Cable length	3D0	3D0 = 3.0M
Linkage	0	0 = None / L = Linkage

Standard panel

When ordering, please check whether the manual control function corresponds to the symbol on the panel.



This foot controller panel could designed suitable for customer's function. Please contact the salesman in the corresponding area of Jiecang for confirmation before placing an order.

Plug

8 pin DIN plug: straight cable: 8D1, coiled cable: 8L1 (suitable for Jiecang straight plug control box)

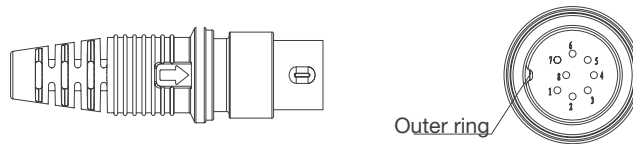

13 pin Din plug: straight cable: 13D1, coiled cable: 13L1 (suitable for Jiecang straight plug control box)

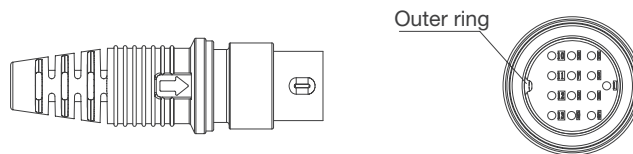

10 DIN RJ elbow flex coiled cable:

straight cable: 10H1; coiled cable: 10P1 (matching with control boxes JCB35T2, JCB35T3 and JCB35T6)

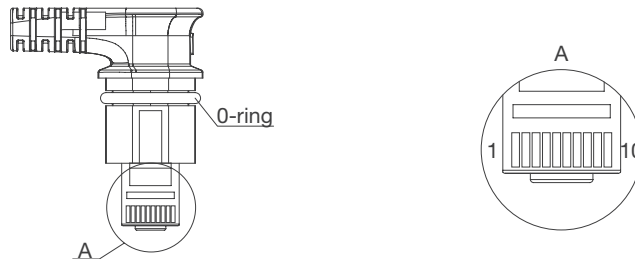

Note: The number of matching actuators is different, and the matching control box model is different, and the plug code will be different. Please contact the salesman in the corresponding area of Jiecang for confirmation before placing an order.

Conditions of Use

It is the user's responsibility to determine the suitability of JIECANG products under specific conditions. JIECANG is committed to providing accurate and up-to-date product information. However, due to the continuous improvement of the product by JIECANG, JIECANG products may be subject to frequent changes without prior notice. Therefore, JIECANG cannot guarantee the correctness and authenticity of the product information described. While JIECANG will do its best to meet order requirement. JIECANG cannot guarantee the deliverability of any particular product for the above reasons. Therefore, JIECANG reserves the right to discontinue the sale of any products listed on the website or product catalogue or other JIECANG written materials. All sales activities must be conducted in accordance with the requirements of the JIECANG Standard Terms of Sale and Delivery. For copies of relevant documents, please contact JIECANG.



Strictly abiding by medical safety certifications

Passed EMC tests. To ensure our products pass all kinds of tests domestic or abroad.



Communication protocol development

Aiming at different applications, develop more extensive functions for control system.



Professional customization

Powerful R&D strength, fully satisfy customers' needs. Development cycle is about 10 days, seizing more market opportunities



Intelligent Control of Bluetooth

Mobile phone as the remote, applying in home care. Market pioneer, Jiecang provides better choices



Wireless Communication

Controllers adopt high-frequency wireless system. It can avoid interference mixing with signal receivers, assisting in remote control over medical equipment.



Latest Weighing System

Designed for physiotherapy beds and medical care beds. Cantilever carrying weighing sensor, it is applicable to different bedsteads dispensing with any adjustment



Notes for mounting and usage can be found in the corresponding mounting manual