

JC35L30 Linear Actuator

Application field - Medical Line

Preferably in medical bed, operation bed and home care bed etc.

JC35L30 is an actuator with high load and low noise capacity, and it has different specifications:

JC35L30-6000N (push); JC35L30-4000N (push); JC35L30-4000N (pull).



General Features

Load in push (N):	6000 4000
Load in pull (N):	4000
Motor rated voltage Input (VDC):	24
Stroke length:	6000N: 50 ~ 300mm (in steps of 4mm) 4000N: 50 ~ 400mm (in steps of 4mm)
Installation dimensions (mm):	L = S+175 (50<S≤250) L = S+185 (250<S≤400)
Colour:	Grey (RAL 7035)
Limit switch:	Built-in (electrical)
Weight:	About 2kg (different stroke length and installation dimensions with different weight)
Noise level:	≤48dB (environmental noise≤40dB)
Static bending moment:	Lateral load is not allowed
Duty cycle:	10%, max. 2min. continuous use
Max IP grade:	IPX6
Options:	Hall sensor, Only push, Safety nut
Standards:	IEC60601-1: 2012 EN 60601-1: 2006+A12: 2014 ANSI/AAMI ES60601-1: 2005/(R)2012 and A1: 2012, C1: 2009/(R)2012 and A2: 2010/(R)2012

Dimension Drawing

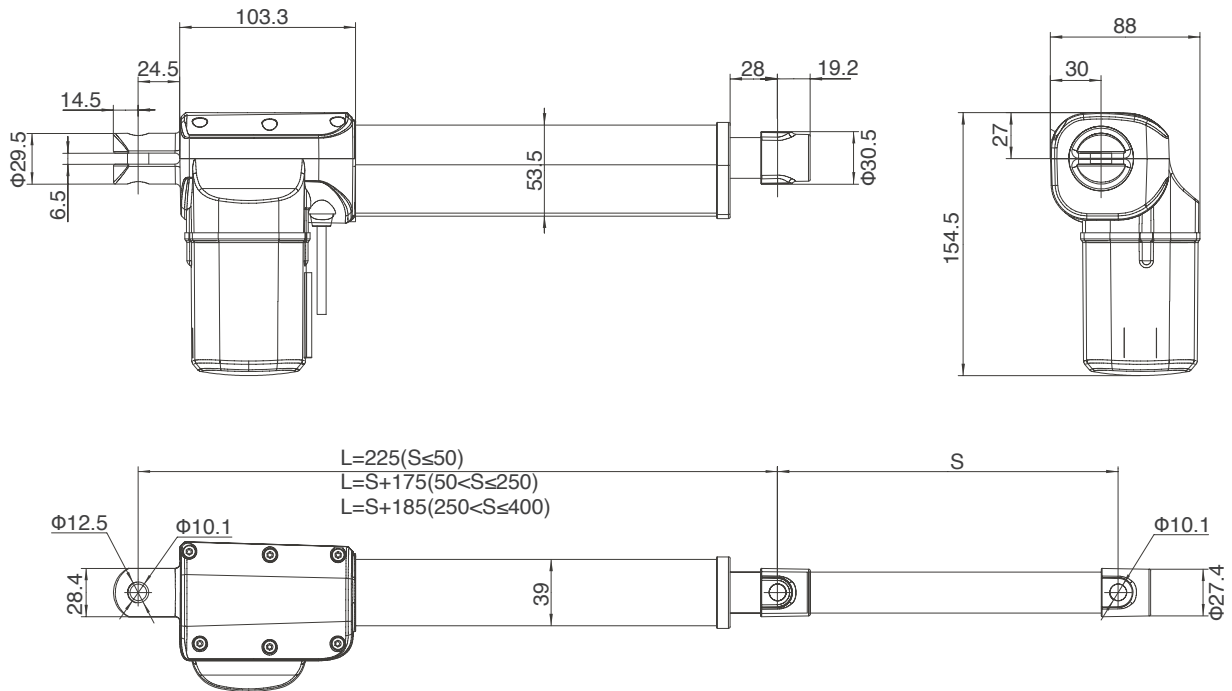

Technical parameters

Power voltage (VDC)	Spindle pitch (mm)	Max.Load capacity (N)	Self locking (N)	Speed no load (mm/s)	Speed full load (mm/s)	Current full load (A)
24	4	6000	6000	5.7	4	4.3
24	5	4000	4000	6.8	5.4	3.6
29	4	6000	6000	6.8	5	4.3
29	5	4000	4000	8.6	6.5	3.6
36	4	6000	6000	8	6.5	4.3
36	5	4000	4000	11	8.5	3.6

Remark: please note the above data are average values at 25°C

Stroke length versus load

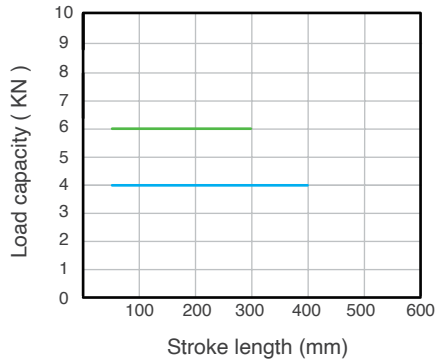

Characteristic

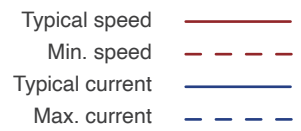

6000N

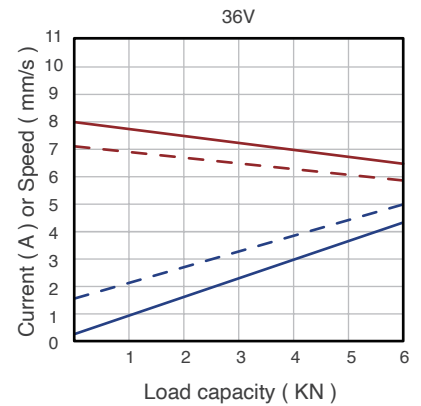
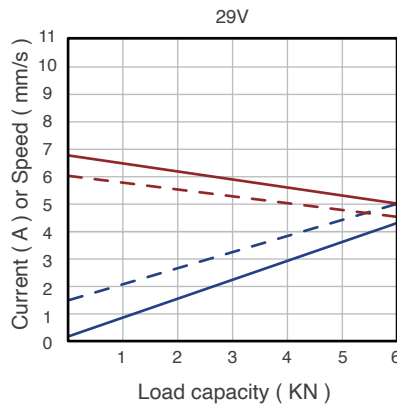
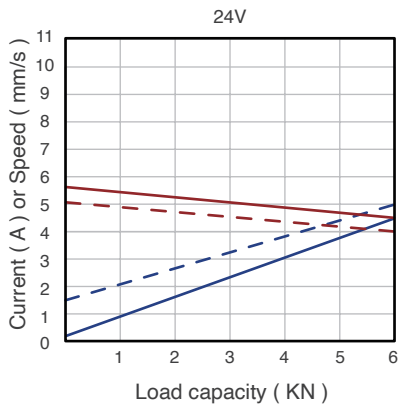

4000N

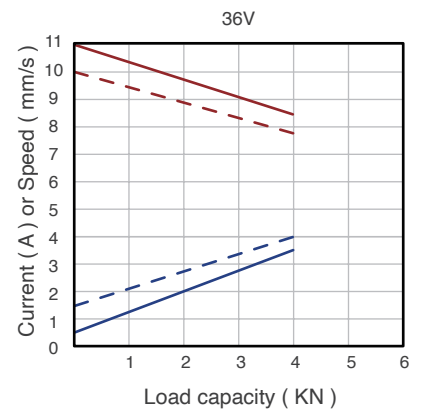
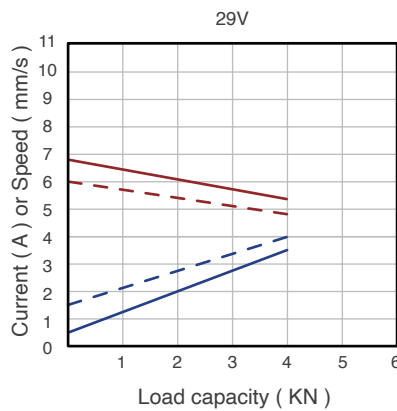
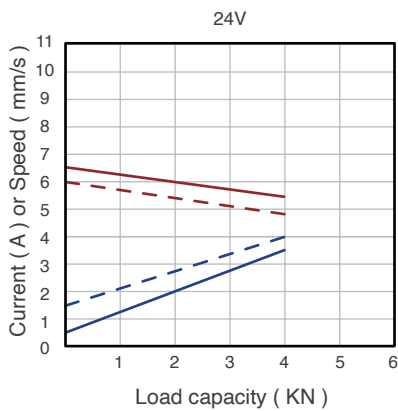

Ordering Key

Take **JC35L3006424200/375HGB34LF162022D0** for example

Model	JC35L30	
Optional features	0	0 = Standard / P = Only push / S = Safety nut / Y = Hall sensor PY = Only push + Hall sensor / SY = Safety nut+Hall sensor
Load in push	6	6 = 6000N / 4 = 4000N
Speed at full load	4	4 = 4mm/s 5D7 = 5.7mm/s
Input voltage	24	24 = 24VDC
Stroke length/ Installation dimension	200/375	Stroke length = XXX Retracted length = XXX
Clevis directions	H	H = H direction / V = V direction
Color	G	G = Grey (RAL7035)
End clevis specification	B34	B34: Slot width 6.5; depth 39, Hole 12.5, with.Hole 10.1 wish bushing B46: hole 10.1 with bushing (black) B47: hole 10.1 with bushing (gray)
End clevis material	L	L = Aluminum alloy
Top clevis specification	F16	F05: Slot width 6.5, Slot depth 26, Hole 12.5,suit withΦ24 aluminum tube. Hole 10.1 wish bushing F16: Hole 10.1
Brake specification	2	0 = No brake / 1 = Pull brake / 2 = Push brake
Type of plug and cable	02	02 = 4 pin DIN plug and 2 pin straight cable 10 = 5 pin DIN plug and 6 pin straight cable
Cable length	2D0	2D0 = 2m / 0D5 = 0.5m

Ordering Details

Dimension drawing of clevis

End clevis: B34

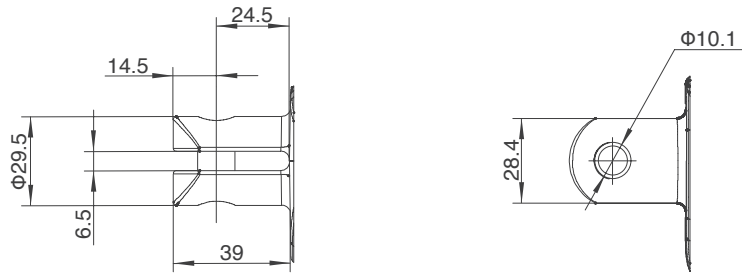

End clevis: B46

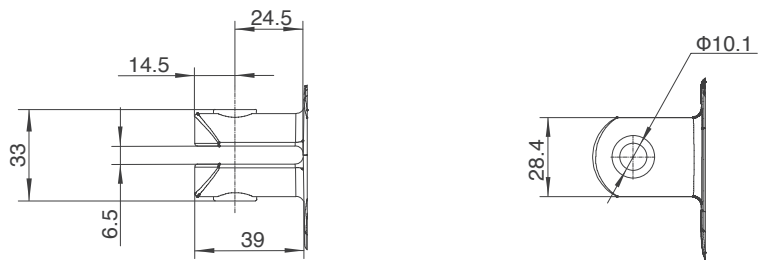

End clevis: B47

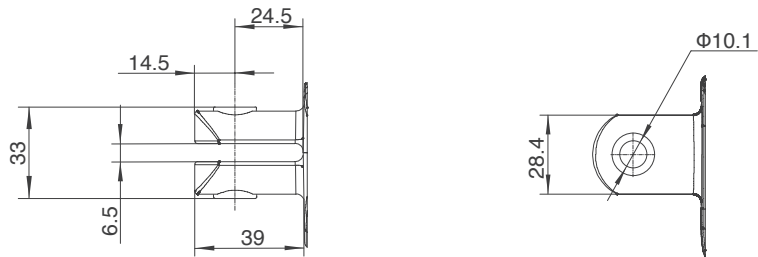

Top clevis: F05

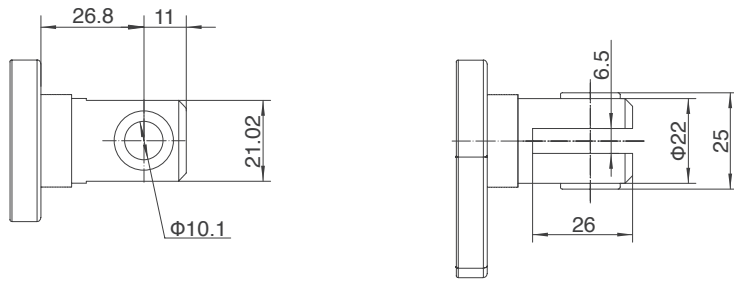

Top clevis: F16

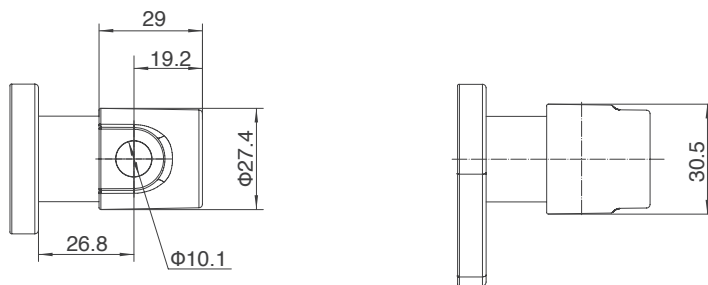

Dimensions JC35L30 with control box

JCB35Q install on JC35L30

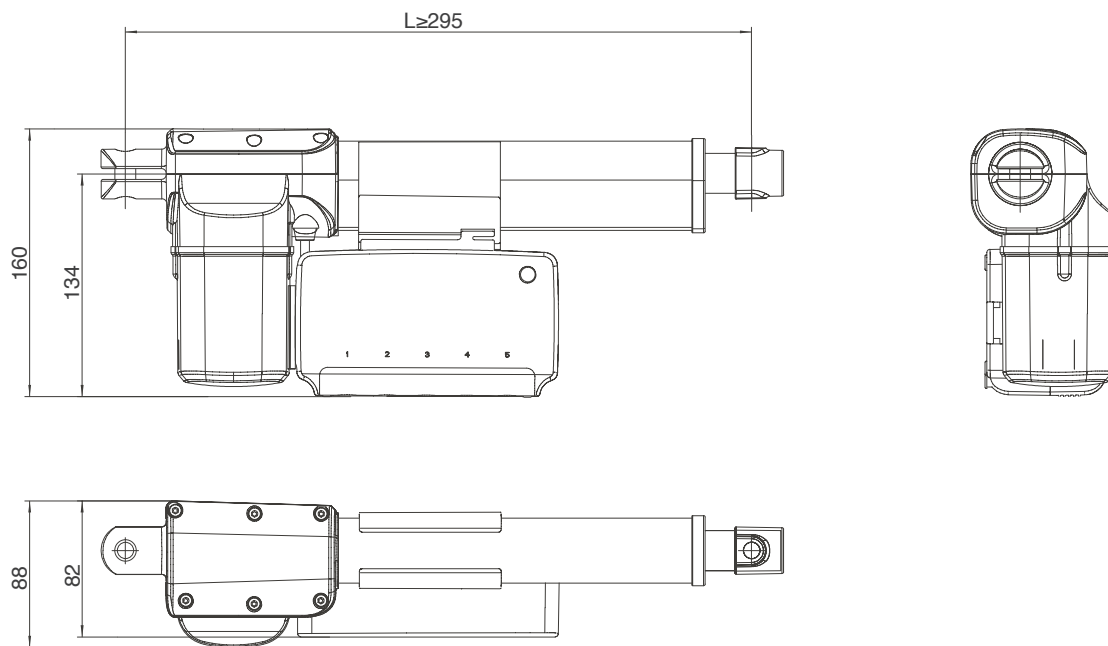

JCB35T install on JC35L30

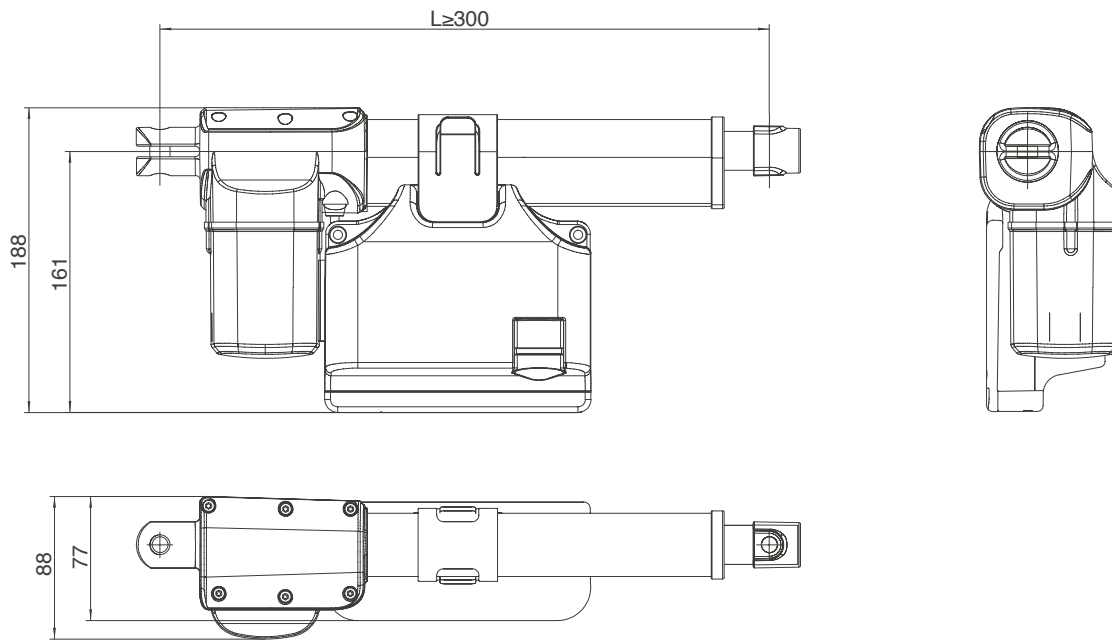

JCB35T2 install on JC35L30

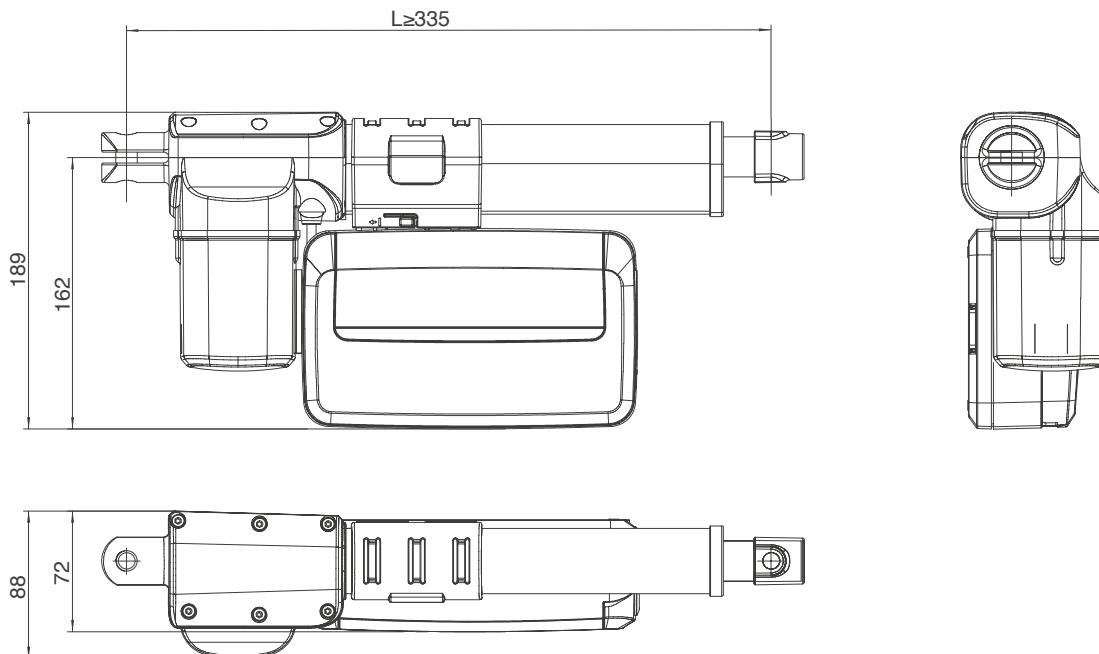

Motor wire

4-pin straight plug (standard)

Matching controller: JCB35Q/
JCB35T/ JCB35R/ JCB35R1/
JCB35S/ JCB35K2

Pin	Color	Function
1	NC	Not connected
2	Brown	When positive voltage power on, actuator will go down
3	Blue	When positive voltage power on, actuator will go up
4	NC	Not connected
Outer ring	NC	Not connected

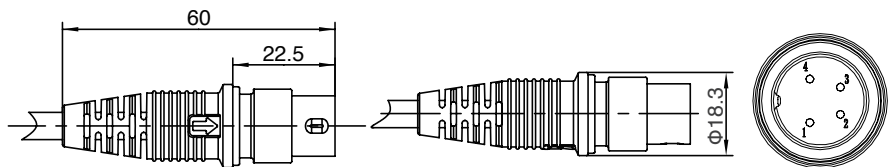

**5 pin DIN plug
(with Hall sensor)**

Matching controller: JCB35Q/
JCB35T/ JCB35R/ JCB35R1/
JCB35S/ JCB35K2

Pin	Color	Function
1	Red	5V
2	Brown	When positive voltage power on, actuator will go down
3	Black	GND
4	Blue	When positive voltage power on, actuator will go up
5	Yellow	Hall signal 1
Outer ring	Orange	Hall signal 2

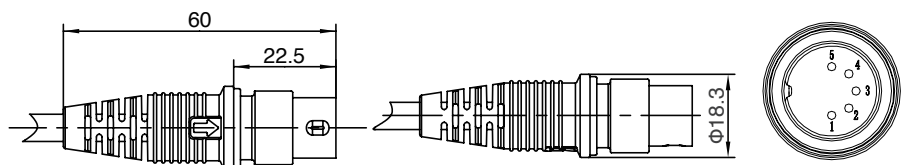



Strictly abiding by medical safety certifications

Passed EMC tests. To ensure our products pass all kinds of tests domestic or abroad.



Communication protocol development

Aiming at different applications, develop more extensive functions for control system.



Professional customization

Powerful R&D strength, fully satisfy customers' needs. Development cycle is about 10 days, seizing more market opportunities



Intelligent Control of Bluetooth

Mobile phone as the remote, applying in home care. Market pioneer, Jiecang provides better choices



Wireless Communication

Controllers adopt high-frequency wireless system. It can avoid interference mixing with signal receivers, assisting in remote control over medical equipment.



Latest Weighing System

Designed for physiotherapy beds and medical care beds. Cantilever carrying weighing sensor, it is applicable to different bedsteads dispensing with any adjustment



Notes for mounting and usage can be found in the corresponding mounting manual